

# QuarttoLino - Babyeinsatz

## Gebrauchs- und Montageanleitung

### Installation and operating instructions for baby insert

- **WICHTIG:**
- Sorgfältig lesen und für späteres Nachlesen aufbewahren
- **IMPORTANT:**
- Read carefully and keep for future reference

**QuarttoLino e.U.**  
Kremstalstraße 96  
4050 Traun, Austria, EU  
[www.quarttolino.com](http://www.quarttolino.com)  
[office@quarttolino.com](mailto:office@quarttolino.com)

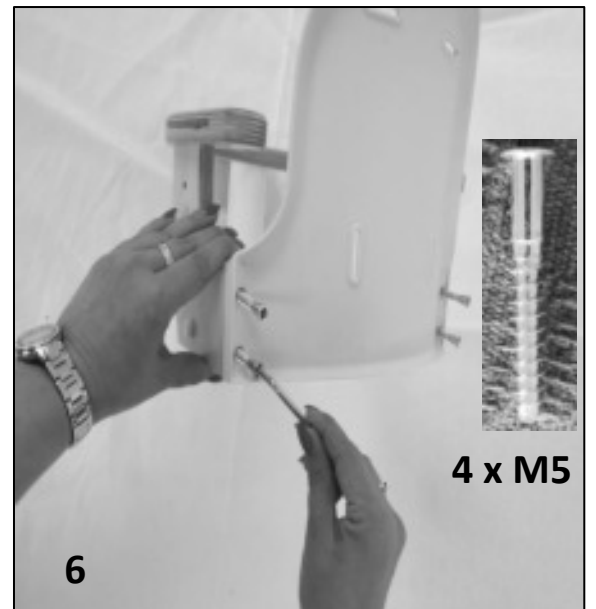
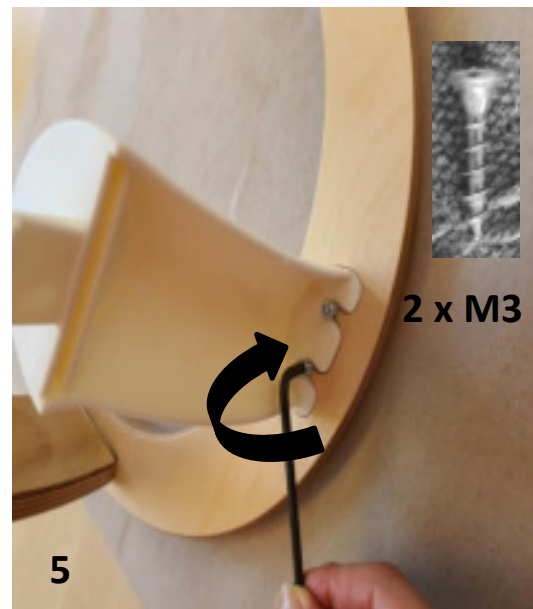
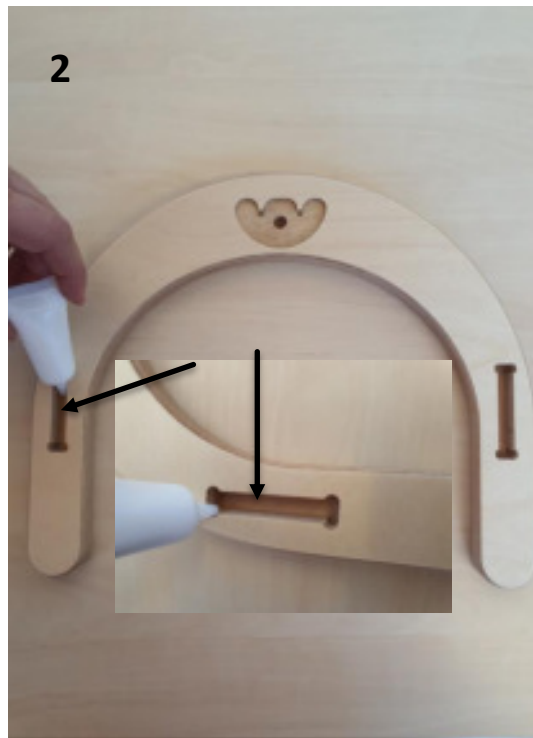



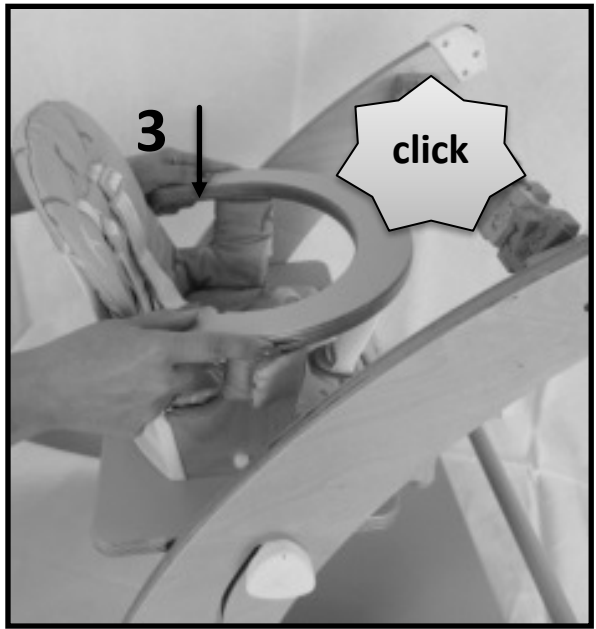
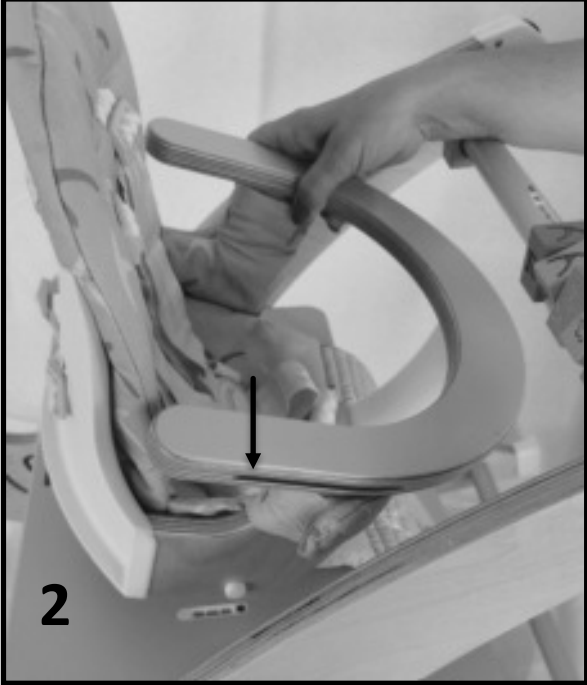
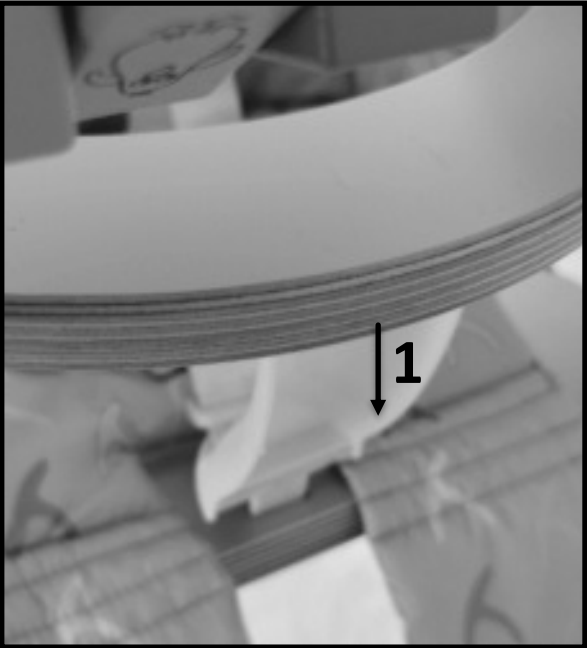

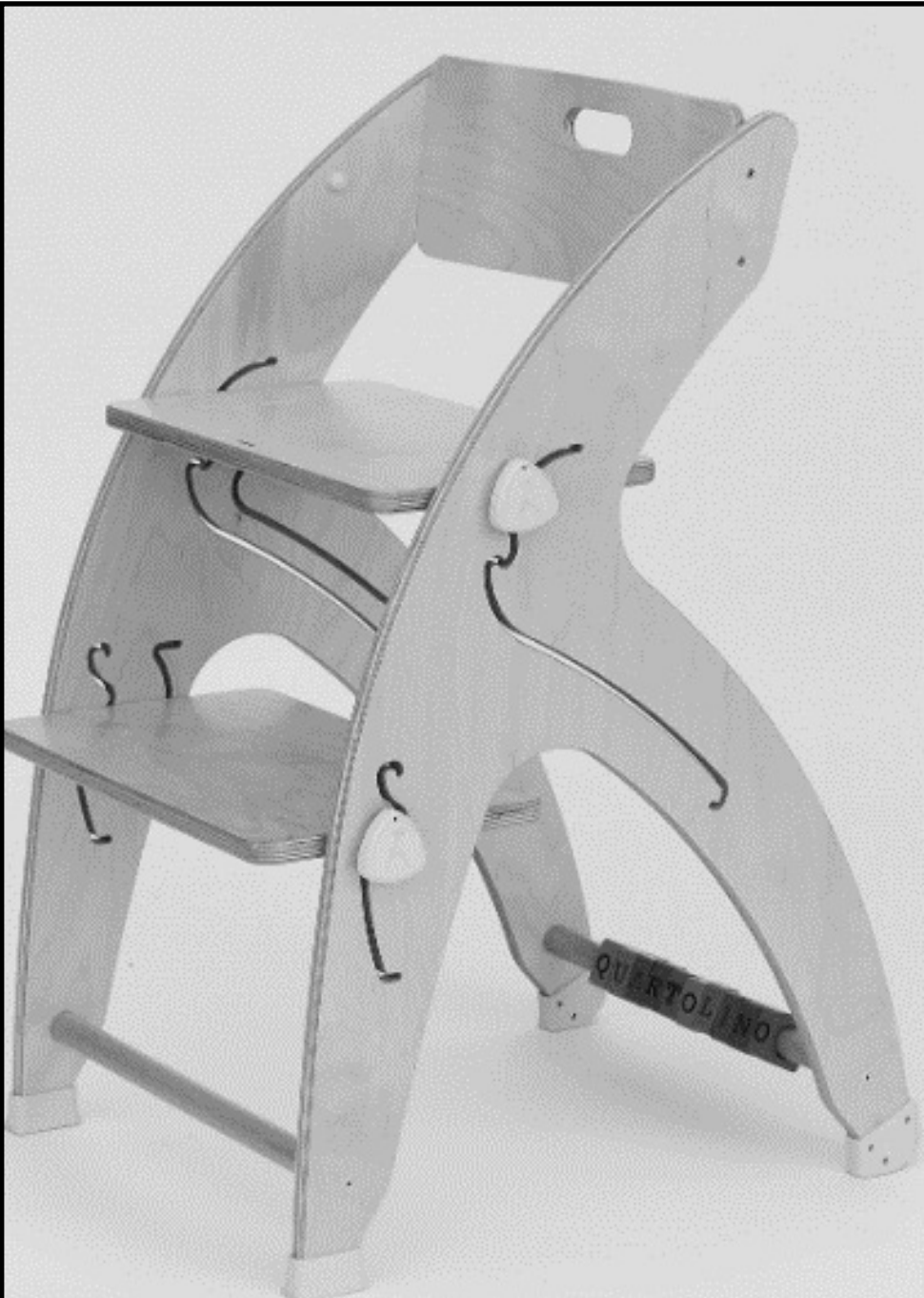

**Warnhinweis! Setzen- und entnehmen Sie niemals die Spielzeuge, während sich Ihr Kind auf dem Stuhl befindet!!!**

**Warning! Never put and remove the toys while your child is on the chair !!!**

## **Quarttolino e.U.**

Kremstalstraße 96

4050 Traun, Austria

Tel.: + 43 676 6740124

Email: [office@quarttolino.com](mailto:office@quarttolino.com)

Web.: <https://quarttolino.com>

**WARNUNG:**

- Das Kind niemals unbeaufsichtigt lassen.
- Immer das Rückhaltesystem verwenden.
- Sturzgefährdung: Das Kind von Klettern auf dem Produkt abhalten.
- Das Produkt nicht benutzen, falls nicht alle Bauteile einwandfrei angebracht und eingestellt sind.
- Auf das Risiko durch offenes Feuer und andere Starke Wärmequellen in unmittelbarer Nähe des Produktes achten.
- Es besät das Risiko, dass das Produkt umkippen könnte, wenn das Kind die Füße gegen einen Tisch oder einen anderen Gegenstand drückt.

**WARNUNG:**

- Benutzen Sie den QuarttoLino Babyeinsatz erst, wenn das Kind selbstständig aufrecht sitzen kann (ab ca. 6 Monaten) bis ca. drei Jahre oder einem Höchstgewicht von 15 kg.
- Lassen Sie das Kind nie unbeaufsichtigt im QuarttoLino Babyeinsatz sitzen.
- Stellen Sie sicher, dass der QuarttoLino Babyeinsatz richtig montiert ist, bevor Sie das Kind hineinsetzen. Man hört ein „Klick“, wenn der Babyeinsatz einrastet.
- Benutzen Sie den QuarttoLino Babyeinsatz nur, wenn alle Bauteile vollständig und einwandfrei sind.
- Benutzen Sie den QuarttoLino nicht, wenn irgendein Teil gebrochen oder gerissen ist oder fehlt.
- Babyeinsatz immer mit Baby Gurt verwenden. Nur original QuarttoLino Baby Gurt verwenden.
- Achten Sie auf das Risiko durch offenes Feuer und andere starke Wärmequellen in unmittelbarer Nähe des QuarttoLino.

**WARNING:**

- **Never leave the child unattended.**
- **Always use the restraint system.**
- **Fall hazard: Keep the child from climbing on the product.**
- **Do not use the product unless all components are properly attached and adjusted.**
- **Beware of the risk of open fire and other strong heat sources in the immediate vicinity of the product.**
- **There is a risk that the product could tip over if the child presses their feet against a table or other object.**

**WARNING:**

- **Only use the QuarttoLino baby insert when the child can sit upright independently (from approx. 6 months) up to approx. Three years or a maximum weight of 15 kg.**
- **Never let the child sit unsupervised in the QuarttoLino baby insert.**
- **Make sure that the QuarttoLino baby insert is correctly installed before you put the child in it. You hear a “click” when the baby insert snaps into place.**
- **Only use the QuarttoLino baby insert when all components are complete and in perfect condition.**
- **Do not use the QuarttoLino if any part is broken, torn or missing.**
- **Always use the baby insert with a baby belt. Use only original QuarttoLino baby harness.**
- **Be aware of the risk of open fire and other strong heat sources in the immediate vicinity of the QuarttoLino.**



## Warning

- Never leave the child unattended in the QuarttoLino.
- Risk of falling: Do not let the child climb around on the QuarttoLino.
- Danger of tipping over: Make sure that the child sitting in the chair does not push his feet off a table or other object.
- Use the QuarttoLino only in the functions provided (swing, children's table with armchair, small stairs or large, low armchair) and only if these are set correctly.
- Only use the QuarttoLino when the child can sit upright alone.
- In combination with the QuarttoLino baby insert, the QuarttoLino is intended for children who can sit independently up to three years or a maximum weight of 15 kg.
- Always use the baby insert with a baby belt. Use only original QuarttoLino baby harness.
- Only use the QuarttoLino when all components have been correctly attached and adjusted. Pay particular attention to the correct alignment and screwing of the seat and foot plates.
- Do not use the QuarttoLino if any part is broken, torn or missing.
- Always place the QuarttoLino on a stable, level surface.
- Always stay within the child's reach.
- Make sure that the child cannot reach toxic or hot substances, pointed or sharp objects or electrical appliances from the QuarttoLino.
- Any additional dishes not provided by QuarttoLino must comply with EN 13210.
- Be aware of the risk of open fire and other strong heat sources in the immediate vicinity of the QuarttoLino.
- Keep children away when opening, closing and closing the QuarttoLino to avoid injuries.
- Only use accessories and spare parts from QuarttoLino.
- Product information: The QuarttoLino is made from birch plywood. It is glue-free glued and treated with water-based, food-safe varnishes.
- Cleaning recommendation: First wipe the wooden parts with a damp and then with a dry cloth. The use of cleaning agents is not recommended. Wipe the seat cushions or machine wash up to 30 ° C, do not iron, do not tumble dry.